

Functionality,
reimagined.

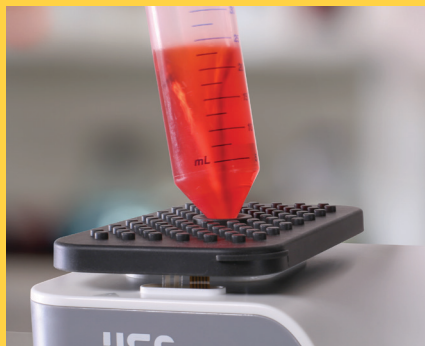

THE VORTEX MIXER



Swirling vortex action aids in quick cell or pellet resuspensions

- **2-IN-1 CONVENIENCE:**
Mix and vortex in one compact device.
- **PRECISE SPEED AND DURATION CONTROL:**
Use the digital presets for quick vortexing or customize for precise mixing.
- **GLOVE COMPATIBLE TOUCHSCREEN:**
Keep gloves on while programming.
- **QUICK TOUCH MODE:**
Press the tube to the standard attachment for quick gentle mixing to vigorous vortexing.

PRACTICAL ELEGANCE

The Vortex Mixer is ideally suited for assay protocols that require gentle mixing, up to resuspensions that require vigorous vortexing.

The standard attachment is used for vortexing tubes up to 3,500 rpm. It can be used in touch mode by applying pressure to the center cup on the base plate or in program mode via the touchscreen. In both modes, the timer will count how long the program is active eliminating the need for an additional timer on the bench. The operation can be controlled at preset or selected speed and duration via the touchscreen.



8010-1000 The Vortex Mixer

Includes the tube and microplate attachments

~~\$459.00~~

**Introductory
price:**

\$395.00



Glove-friendly touchscreen for simple programming. No need to remove your gloves to program the reactive touchscreen. The intuitive interface includes a sleep mode and brightness settings.

EASY PROGRAMMING, EVEN WITH GLOVES!

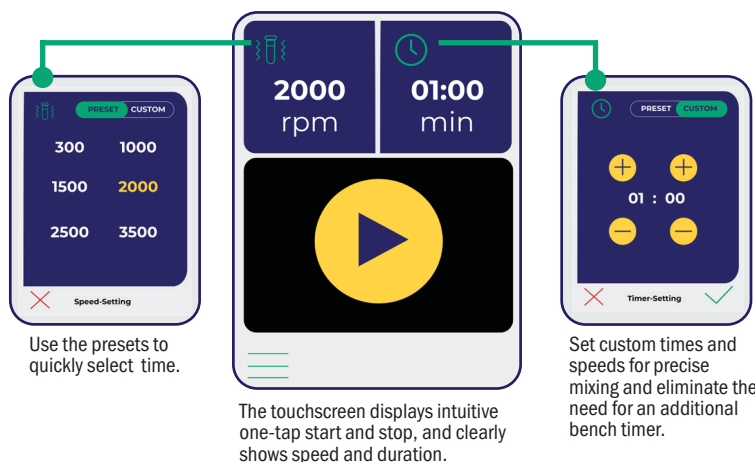

Mix up to 15 tubes with the tube adapter.

COMBINE THE POWER OF A VORTEXER WITH THE VERSATILITY OF A MIXER IN ONE COMPACT UNIT



TOUCH MODE WITH THE STANDARD ATTACHMENT

Start and maintain vibration with the standard attachment with simple pressure to the top of the pad. The included standard attachment essential tool is designed for seamlessly mixing single or multiple tubes at speeds of up to 3,500 rpm, ensuring precise and efficient results.



PROGRAM MODE WITH TUBE AND PLATE ADAPTERS

1.5/2.0 mL Tube Adapter (8010-0011): Mix individual tubes with the tube adapter. Fill the insert with up to 15 tubes for simultaneous mixing.



Microplate Adapter (8010-0012): Mix a variety of microplates with the microplate adapter. With the adapter for microplates attached the maximum preset speed defaults to 1,500 rpm.

SPECIFICATIONS:

Max Speed:	
Standard Attachment	300 to 3,500 rpm
Adapter for 1.5/2.0 ml tubes	300 to 1,500 rpm
Adapter for microplates	300 to 1,500 rpm
Noise level:	≤55 dBA
Power adapter operating voltage:	100 to 240 V~, 50 to 60 Hz
Unit input:	24 VDC 12 W
Weight:	≤2.8 kg 6.2 lb.
Dimensions (W×D×H):	200 × 130 × 103 mm (7.9" x 5.2" x 4.1")
Ambient temperature for operation:	2° to 40°C (36°-104°F)
Relative humidity for operation:	≤80%
USB Output:	5 VDC 1 A
Warranty:	2 Years



Schedule a demo!

Limited time introductory special:
Get the optional adapters FREE
 when you purchase the Vortex Mixer (8010-1000).

USn
 SCIENTIFIC
 SIDE BY SCIENCE
usascientific.com/vortex_mixer